



Gantry Assembly Aid

➤ Instruction Document

> Introduction

Prior to fitting the **Assembly Aid** to your gantry, please read the **PORTAGANTRY™ Assembly & Operations Guide** carefully, before using or operating the system.



This guide contains important information about how to handle and use the system in a safe and efficient way, avoiding danger, reducing repair costs and downtime, and increasing the reliability and lifespan of the system.

They apply for:

- > **Operation, including preparation, troubleshooting during operation and cleaning**
- > **Maintenance, inspection and repair**
- > **Transportation**

It is the responsibility of the end user to adhere to the Health & Safety and accident prevention standards and legislation valid in their respective countries and any regions in which the system is being used.

It is also incumbent on the user or competent person to ensure that anyone working with the equipment has the necessary medical and physical capabilities. A rescue plan also needs to be in place in the event of an emergency that could occur during the work.

The Assembly & Operation Guide, plus this document should form part of the overriding Risk Assessment and Method Statement required for each lift.

➤ Assembly Instructions



The Assembly Aid comes with:

1. 4 clamping assemblies with shackle points
2. 2 clamping leg assemblies with swivel castor

The Snap Hook Strop Kits comes with the Assembly Aid as well as:

3. 2 Masterlinks
4. 6 snap hook to snap hook straps, depending on the size of the Gantry.



- Raise the Porta Gantry A-Frame off of the ground, by approximately 500mm.



- The Assembly Aid components are now ready to be installed.

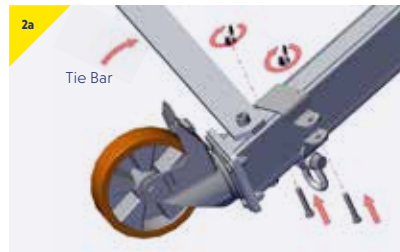

- Bring the shackle assembly to the leg whilst facing them inwards, fit them as close as possible to the tie bar. Use the bolts and wingnuts provided to secure the assembly aid to the legs (one in each leg).



- Bring the wheel assembly to the strut and fit them as close to the top of the trap plate as possible. Use the bolts and wingnuts that are provided to secure the assembly aid to the legs. Make sure that it is fitted in the correct orientation so that it allows for the wheel assembly to fold down when not in use.

> Assembly Instructions

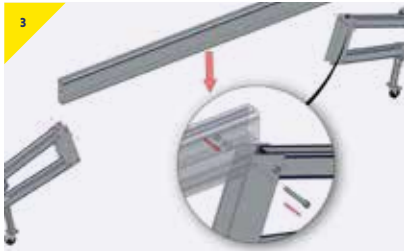

- > Place the beam on the A-Frames as per the usual gantry assembly (Refer to Gantry Assembly and Operations Guide).



- > Use the suitable straps to connect on to each shackle point on the gantry, this should form a 'V'.



- > Connect the additional strap to reach the pulling device selected.
Strap Kits are available from REID.



- > Connect all the straps to the pulling device, locate the pulling device around the centre of the beam. The image above is showing a Tirfor, a chain block can also be used in this instance.



- > Put the brake on A-Frame **A** to erect A-Frame **B** with the pulling device.



- > Once A-Frame **B** has met the beam, the wheel assembly can now be folded away. Use the pin provided to retain the position.
Strap Kits are available from REID.



- › Secure A-Frame **B** to the beam by placing the bolt provided with the A-Frame.



- › Put the brake on A-Frame **A** and take off the brake on A-frame **B**.



- › Erect A-Frame **A** with the pulling device. Once A-Frame **A** is in position, the wheel assembly can now be folded out of the way. Use the pin provided to retain the position.



- › Secure A-Frame **A** to the beam by placing the bolt provided with the A-Frame.



- › The Gantry system is ready for use.

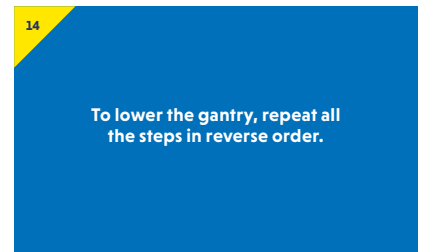

To lower the gantry, repeat all the steps in reverse order.

> Contact Us

Head Office, UK

Unit 1 Wyevie
Newhouse Farm Industrial Estate
Chepstow
Monmouthshire
NP16 6UD
United Kingdom

- > +44 (0)1291 620 796
- > enquiries@reidlifting.com
- > www.reidlifting.com

All information herein is copyright protected by REID Lifting Ltd. All company and product names are Trade Mark and Trade Name protected and all REID Lifting Ltd. Product IPR is protected under Patents, Patents Pending and/or Design Rights.

 Printed using environment friendly processes and materials.